



The Steelhead High Speed series is designed with the medium to large bottler in mind. Systems are available in speeds from 450 to 3000 bottles per hour. All systems can accommodate 3 or 5 gallon size bottles as well as push or screw on capping.

**All of our washer systems feature as standard:**

- Made of Heavy Duty 12 GA. Stainless Steel
- 3, 4, 6, 8, or 10 Bottles per Wash Cycle
- Automatic Gentle Bottle Load and Unload System
- Removable Spray Bars for Ease of Maintenance
- AC Frequency Controlled Gear Drive Motor for Precise Chain Movement -
- Quick Latch Removable Large Window Access Throughout
- Multiple Quick Latch Removable Large Tank Access for each Tank
- PLC, Motor Starters, and Controls in a NEMA 4 Enclosure
- Color Touch Screen Control System
- External Pre-Mounted SS Pumps And Plumbing For Easy Maintenance
- Complete Steam Heat Exchanger System and Controls (or gas boiler)
- Automatic Wash Detergent Feed System
- Pre-Piped Drain Manifold to Connect all Tanks to Floor Drain
- Automatic Ozone Sterilization System for Bottle Sterilization
- Low Profile Footprint Allows For Good Observation Of Process
- Exclusive Bottle Neck Sprays Integrated In Washer
- Meets or Exceeds IBWA and NSF standards for contact times
- Automatic Ozone Sterilization System for Bottle Sterilization



**All of our filler systems feature as standard:**

- Made of Heavy Duty 12 GA. Stainless Steel
- 3, 4, and 6 Spout In line designs up to 1500 bottles per hour
- 15 and 21 Spout rotary designs for 1800 to 3000 bottles per hour
- Efficient Design Provides Gentle Filling and Movement of Bottles
- For Rotary: Continuous, Smooth Bottle Discharge enhances Capping Operation
- SS Fill Spouts with Integrated Connectors for CIP Cleaning. Each fill head has separate high and low speed valves located on top of filling head so that product shut-off is immediate without siphoning from distribution hoses or manifolds.
- All Piping and Material in contact with product water 316L Stainless Steel, Viton or EPDM Joints.
- Non Contact Filling System Eliminates Cross-Contamination and Bottle Pressurization
- Multi Stage Adjustable Time Filling provides No Spill, Accurate Level Fill
- SS Enclosed Filling Area with High Visibility Windows and Access Doors with Safety Interlocks.
- Hospital Grade Positive Pressure Air Filtered System (HEPA – Class 100)
- Tri-clamp SS Product and Drain Connection
- Filler equipment with complete drip pan channeling drips to single point drain system – self draining.
- All materials in contact with product water complying with FDA Specifications.



## All of our capper/hopper systems feature as standard:

- Made of Heavy Duty 12 GA. Stainless Steel
- Motorized stainless steel rotary capping pressure belt with speed control
- Stainless steel centrifugal feeder bowl for cap orientation
- Automatic cap level control in feeder bowl activates supply from hopper
- No cap in chute alarm
- Height adjustable cap chute
- Filtered air to capper @ .2 micron.
- Capper enclosure tied to filler blower filtration system for positive pressure.
- Cap elevator with floor level hopper (304 SS Construction)
- Automatic Hopper – Elevator activation based on Cap Sorter Demand, with Low Cap Warning. Elevator feeds directly to Cap Sorter.
- Minimum 1 hour hopper capacity
- Caps can be dumped in at floor level
- Cap clean out for all floor level hoppers
- Conveyed by electro mechanical belt drive to the capper; alimentary chain conveyor.
- Fully enclosed sanitary hopper and elevator design – eliminating cap contamination by dust or other foreign materials once in hopper.



## All of our bottle conveyors feature as standard:

- Made of Heavy Duty 14 and 12 GA. Stainless Steel
- Stainless steel or habisat belt styles available
- Heavy duty Eurodrive gear motor systems
- Self draining, easy to clean design
- Adjustable legs for uneven floors
- Controls interlocked with bottling system
- Covered and fully enclosed options for bottle protection



## Many Line Options Available

- Inserting Sprays for the washer
- Brushes
- Extra spray positions
- Multiple ozone injection points, or alternate chemical sanitizing
- Multiple heat options available
- Monoblock or expanded layouts
- Monitoring Options
- CIP connections and programs
- Push on or screw capping systems
- PLC and control platforms in Siemens, Allen Bradley and Omron
- Custom layouts
  - Auxillary line items such as decapping, testing, rack loading and more

# Sample Layouts

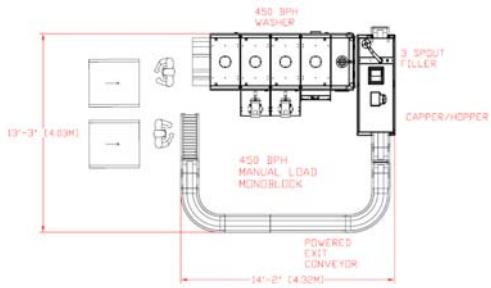

450 bph manual load monoblock

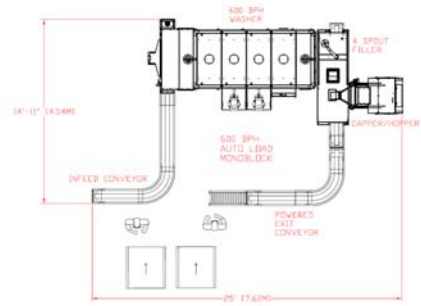

600 bph auto load monoblock

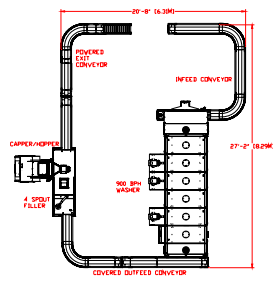

900 bph auto load extended layout

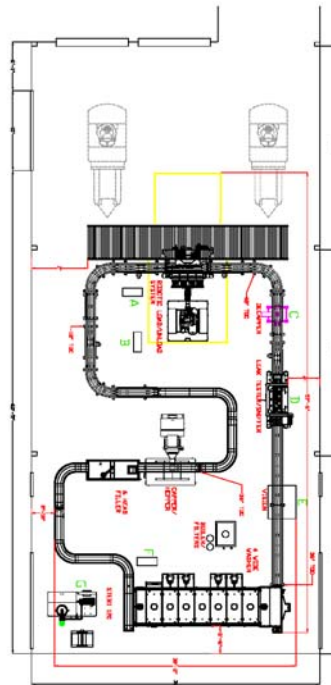

1200 bph fully automated layout

2400 bph fully automated layout

